

Meeting Room Pricing

Complete Conference Center

Rental \$400

Sunrise Room

(Breakfast Room)

Rental \$175

Sunset Room (A & B)

Rental \$225

Sunset A Rental \$100

Sunset B Rental \$125

Sunrise w/Sunset B

Rental \$300

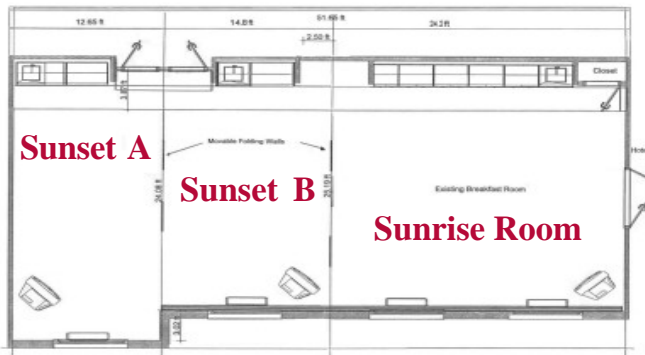

BREAK MENU

Design your own morning break, cookie break or continental breakfast. Please see our catering menu for additional meal options.

Basic Break

The basic break includes coffee, tea and juice for \$2.50 per person.

Options

Each additional option is \$1.00 per person.

- Perkins Café & Bakery Mammoth Muffins: Blueberry, Apple Cinnamon, Banana Nut, Chocolate Chocolate Chip, Peaches n' Cream, Raspberry n' Cream, Bran, Cranberry Nut, Lemon Poppyseed...
- Perkins Café & Bakery Fudge Walnut Brownies
- Perkins Café & Bakery Cookies: Chocolate Chip, Oatmeal Raisin Walnut, Peanut Butter Chocolate Chip, Macadamia Nut or Sugar, as available.
- Soft drinks -assorted variety of Coke and Pepsi products and Rocky Mountain bottled water.
- Milk
- Bagels with cream cheese
- Mini fruit or cream cheese Danish
- Assorted mini-muffins
- Donuts
- Whole fruits
- English muffins & jam

Audio/Visual Rentals

Displays

8' X 8' Screen	\$35.00
5' X 5' Screen	\$20.00
Flip Chart	\$20.00
White Board	\$25.00

Audio Equipment

Mixer Audio Inputs	\$20.00
CD Player	\$30.00
Cassette	\$30.00
Wireless Mic (Lavalier)	\$75.00
Lavalier Mic	\$25.00
Podium W/Microphone	\$35.00
Keyboard	\$35.00

Visual Equipment

Overhead Projector	\$30.00
High intensity TV	\$40.00
TV	\$40.00
VCR / DVD player	\$35.00
Slide Projector	\$25.00
Laser Pointer	\$20.00
LCD	\$100.00

A/V Extra's

Power Strip / Cord	\$5.00
2-Line Speaker Phone	\$35.00
Conf Phone Station	\$60.00
8-Port Internet Hub	\$55.00

MEETING ROOM STATISTICS w/approximate Seating

(9' + High Ceiling)	Dimensions	Square Feet	Theatre	U-Shape	Boardroom	Classroom	Reception	Banquet	(Rounds) Banquet
Complete Conference Center	52' x 25'	1,300	120	48	75	70	140	100	80
Sunrise (Breakfast)	24' x 25'	600	55	24	35	32	65	46	32
Sunset (A&B)	28' x 25'	700	65	28	40	36	75	50	40
Sunset A	13' x 25'	325	30	12	20	16	35	20	
Sunset B	15' x 25'	375	35	16	20	20	40	20	
Sunrise w/Sunset B	39' x 25'	975	90	36	55	52	100	66	



Making Your Event a Success

If you're looking for a place to have a personalized, successful function, look no further. Whether your function is for your company meeting, training seminar, board-room or classroom, wedding breakfast, or reception, we have the facilities and attentive staff that will make your event extraordinary!



Salt Lake City Airport

230 North Admiral Byrd Road
Salt Lake City, UT 84116

(801) 355-3331 or Toll Free: (866) 355-3331
www.sla-ffi.com or www.marriott.com/SLCFA

Salt Lake Airport



Meeting Facilities



 **FAIRFIELD
INN & SUITES.**

